

NEMA 5-15 15A

EV Charging Cable and Plug with Dual Thermistors



Volex NEMA 5-15 15A EV charging grid cables and plugs are used in mode 2 AC charging cable assemblies to charge battery-powered (BEV) or plug-in hybrid electric vehicles (PHEV).

EV charging grid cables can be used with any domestic or household socket outlet and connect to the In-Cable Control and Protection Device (IC-CPD), allowing drivers to safely charge their electric vehicle without the need for a dedicated circuit or EV charging station.

All Volex electric vehicle charging grid cables and plugs meet industry standards, regulatory, and country-specific compliance requirements, ensuring compatibility with various regional grid plug interfaces.

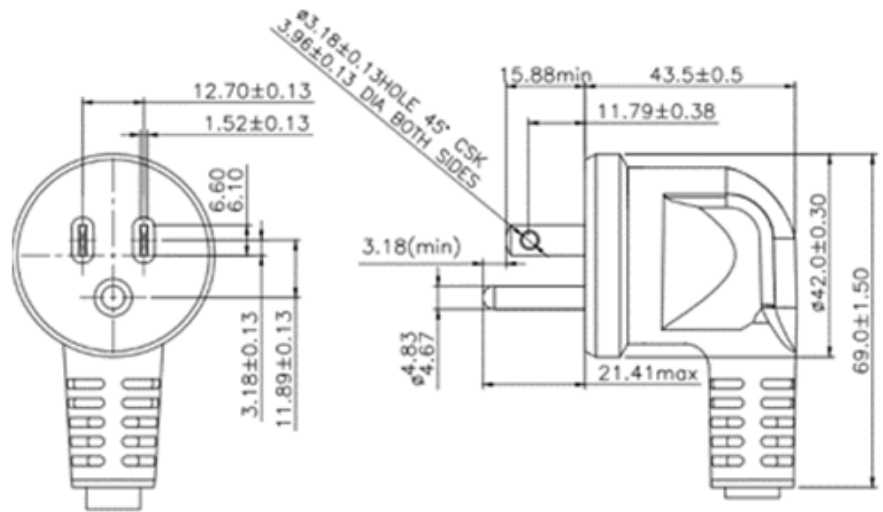

TECHNICAL INFORMATION

Cat. No.	ATUS15THA3
Description	Angled 15A Plug
Standard	UL 817, CSA C22.2 No. 21
Max. Rating	15A 125V
IP Rating (Match with wall socket per safety standard)	IP 20
IP Rating of Plug	IP 67
Cable Type	EVJE 3x14AWG + 3x20AWG

Contact us at sales@volex.com
for assistance in finding the right solution for your needs.