

IEC Type 1

AC Charging Cable



| PRODUCT DEFINITION | | |
|---|--|-----|
| Charging Standard | Type 1 | |
| Standards / Regulations | IEC 62196-1,-2 | |
| Approval | TUV | |
| DIMENSIONS CHARGING CONNECTOR | | |
| Width | 50.4 mm | |
| Height | 90 mm | |
| Depth | 215.6 mm | |
| Cable Length | On Request | |
| AMBIENT CONDITIONS | | |
| Ambient Temperature (Operation) | -30°C to +50°C | |
| Ambient Temperature (Storage / Transport) | -40°C to +80°C | |
| Max. Altitude | 2500 m (above sea level) | |
| Degree of Protection (Unmated) | IP67 | |
| Degree of Protection (Mated) | IP44 | |
| Degree of Protection (Protective Cap) | IP54 | |
| ELECTRICAL PROPERTIES | | |
| Number of Phases | 1 | |
| Rated Voltage for Power Contacts | 250V AC | |
| Rated Current for Power Contacts | 16A | 32A |
| Maximum Charging Power | 4 kW | 8kW |
| Number of Power Contacts | 3 (L1, N, PE) | |
| Rated Voltage for Signal Contacts | 30V AC | |
| Number of Signal Contacts | 2 (CP, PP) | |
| Note on the Connection Method | Crimp Termination (cannot be disconnected) | |
| Resistor Coding (between PE and CS) | 480 Ω (lever operated) 150 Ω (lever not operated) | |
| MECHANICAL PROPERTIES | | |
| Mating Cycles | > 10,000 | |
| Insertion Force | < 75 N | |
| Withdrawal | < 75 N | |

IEC TYPE 1 MECHANICAL DRAWING

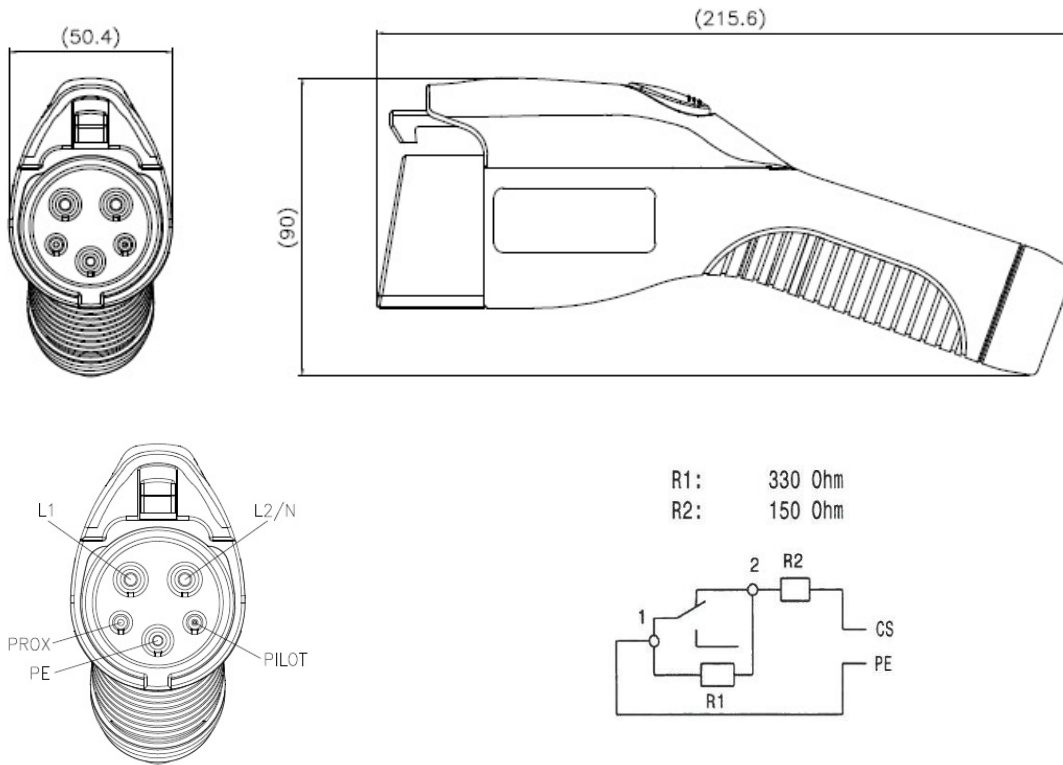

| MATERIAL | | DESIGN | |
|----------------------------------|---|------------------------------------|------------|
| Material Housing / Handle Area | Plastic | Housing / Handle Area Colour | Black |
| Material Mating Face | Plastic | Mating Face / Locking Lever Colour | Black |
| Material Protective Cap | Soft Plastic | Protective Cap Colour | Black |
| Flammability Rating | V0 | Housing with Customer Logo | On Request |
| Material Contacts | Cu-Alloy | | |
| Plating | Silver Plating | | |
| CABLE | | | |
| AMPERAGE | CABLE STRUCTURE | CABLE O.D. | PHASE |
| 16A | 3 x 2.5 mm ² + 1 x 0.5 mm ² | 10.5 mm | 1 Phase |
| 32A | 3 x 6.0 mm ² + 1 x 0.5 mm ² | 12.8 mm | |
| CABLE RESISTANCE AT 20°C | | | |
| 6.0 mm ² | 2.5 mm ² | 0.5 mm ² | |
| ≤ 3.30 Ω/km | ≤ 7.98 Ω/km | ≤ 39.00 Ω/km | |
| Cable Standard | EN50620 | | |
| Type of Conductor | Straight (or more type on request) | | |
| Outer Sheath Material | TPU Compound | | |
| Outer Sheath Colour | On Request | | |
| ENVIRONMENTAL PRODUCT COMPLIANCE | | | |
| REACH SVHC | Compliant | | |
| China RoHS | Compliant | | |
| EU RoHS | Compliant | | |

Contact us at sales@volex.com
for assistance in finding the right solution for your needs.